

Automatic Pumping System

Instruction

What is Automatic Pumping System (APS)?

APS - ST is designed for easy use by adapting new tubing system developed by Autoalex which is attachable and detachable with 4 rollers increasing durability.

It can be available in every use to pump up the water, especially for other brand incubator.

 APS-PRO is originally designed for the incubators which have no humidity control function.

Since the user can read humidity in the egg chamber and even control the humidity by simple attachment, it is very handy to use with the non humidifying control incubators.

1. Basic componentry

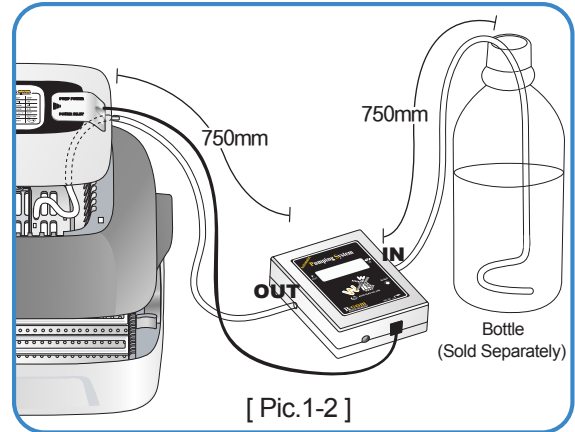
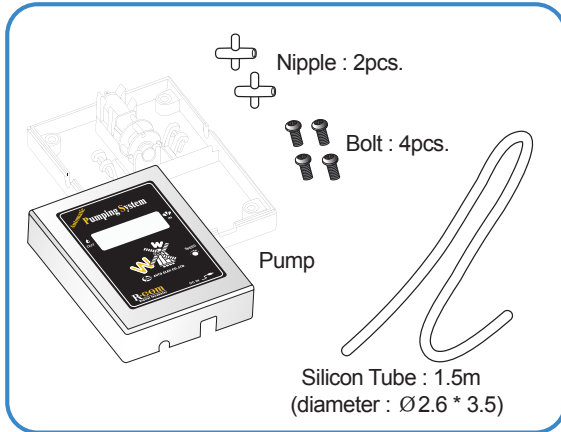

2. How to Use APS

2-1. How to Assemble

▶ Cut the silicon tube to 35 mm.

▶ As shown on the picture, fully insert the tube to the nipple. Then, cut the tube remaining certain length to use. Insert the tube end to the other nipple. [Pic.1-3]

 **Insert silicon tube to 35 mm fully to the nipple for the perfect performance.**

▶ As shown the picture, place the nipple on the pumping motor frame after unscrewing 4 bolts on the APS case. [Pic.1-4]

▶ Place the silicon tube on the grooves for water-in and water-out on the case with tension. Then, cover up the case with care. Be careful not to be caught the tube or electric wire by the case. Then, screw 4 bolts.

▶ Silicon tube assembled to incubator is like shown on the [Pic.1-2]

2-2. How to Operate

▶ Connect APS power cord to the incubator. [Pic.1-5]

▶ After connecting incubator power cord, keep pressing (+) key more than 5 seconds. If the motor is working here, it is completed.

▶ For pumping test, insert water-in tube into a bottle with tap water. [Pic.1-2]

▶ After connecting the water-out tube to the nipple on the incubator, keep pressing (+) key more than 10 seconds, the water is pumped up and automatically stop after 2 min. Press any key to stop pumping operation.

※ A bit of water goes into the chamber with slow speed.

