

Trouble shooting the **RCOM KING SURO**

Issues that could occur with the RCOM KING SURO and possible solutions.



If the unit is not reacting properly

In a lot of cases when the unit is not responding as it should. It could be that the unit is not reacting to adjustments or there could be issues with the temperature and humidity settings. Often this can be remedied by simply returning the unit to the original factory settings.

Return to Factory Setting

- ▶ This function is for return incubator to factory setting.
- ▶ Unplug power cord. Replug during  button is pressed. Then, "rSt AL" will indicated in display, and incubator return to factory setting. (Default setting)

 **Tip** Calibrated temperature and humidity will also return to factory setting.

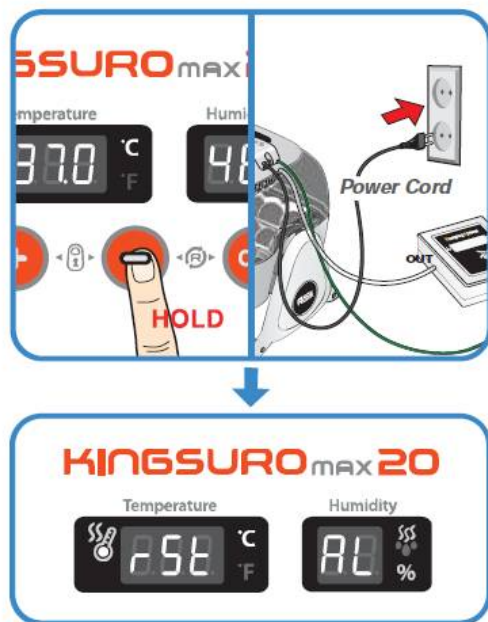

Humidity

Insufficient humidity:

1. If you've just set the incubator up for the first time and you're not able to get the humidity high enough, check the following:
 - Make sure that the APS (humidity pump) motor is running. If not check the connection of the power cord and the unit;
 - Check the silicone tube, make sure that it is not twisted or kinked and that it is fed through the APS correctly.

- Ensure that the lengths that the silicone tube have been cut are as described in the instructions. If the silicone tube is not cut according to the instructions, performance of the APS (humidity pump) can be affected.
- See that the humidity pad is in fitted correctly and that the water drops onto the pad.

If you've checked all of the above you can turn the 'Speed' screw on top of the APS clockwise to increase the supply of water from the APS.

2. If you've used the unit before and have not experienced this problem in the past, check the following;
 - Make sure that the silicon tube is not blocked or restricted in any way.
 - Make sure that the APS (humidity pump) motor is running. If not check the connection of the power cord and the unit;
 - See that the humidity pad is still positioned correctly and that the water drops onto the pad. Check that the humidity pad is still in a good condition.

Humidity too high

- If the humidity is too high make sure that there is no water in the bottom of the unit
- If you have a hygrometer verify that the displayed humidity is correct.
- Once you've checked the above and the humidity remains higher than what you've set it at you can turn the 'Speed' screw on the APS anti-clockwise to reduce the flow of water to the humidity pad. Remember that if the humidity is soaking wet the humidity will not go down immediately so give any changes you the time to adjust.

If you've come to the conclusion that the humidity is correct but is being displayed incorrectly you can recalibrate the unit.

Humidity Calibration

- ✳ After temperature calibration, it goes to humidity calibration.
- ▶ When humidity display is blinking, adjust humidity according to your needs with **+** and **-** button by 1%.
- ✳ Measurement error of hygrometer which you can purchase from market is bigger than thermometer's.

 If you use this function wrongly, initialize the incubator to factory setting.



 If you want to up incubator humidity 0.5%, you should calibrate 0.5% lower in calibration mode.

Temperature

Temperature too high

Many bird breeders add a separate thermometer to make sure that the temperature that is displayed on the unit is in fact correct. If the displayed temperature is too high, check the following;

- Firstly, make sure that the thermometer you're using is accurate.
- If the temperature is constantly higher than what is displayed you can recalibrate the unit.

Temperature too low

If the temperature is too low and does not increase check if the element is heating up and while you do that check that the fan is working.

* If the displayed temperature is incorrect you can recalibrate the temperature readout.

Temperature Calibration

- ▶ Press **+**, **-** and **O.K** button at the same time. Then "CA" will indicated for about 0.5sec, and it changes to current temperature. (CA means Calibration.)

Tip If you want to increase the temperature 0.5°C, Please reduce 0.5°C in calibration setting mode.

- ▶ You can control temperature by 0.1°C with **+** and **-** button.

- ▶ Press **O.K** button after calibration finished then it saves the calibrated value. After that, it goes to humidity calibration.

Tip If you use this function wrong, initialize the incubator to factory setting.



The Cradle

A common problem with the cradle is that it jerks as it move or makes a squeaky noise. It is caused by dryness of the moving parts.

Fortunately this is a relatively easy fix. In most cases adding a bit of petroleum jelly or spraying a bit of silicone spray where the crank bar connects to the turning base and the motor will solve this issue.

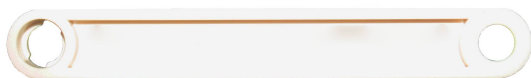

The crank bar.

If you've tried the above and still not found the solution for your problem, please do not hesitate to contact us; brooderincubator@gmail.com